

Everything has its place.  
Recycle right!  
Read & use these guidelines.



2011 -12 Collection  
Calendar Enclosed

Waste Management  
720 4th Ave, Suite 400, Kirkland, WA 98033  
Online 24 hrs.: [wmnorthwest.com](http://wmnorthwest.com)  
Información en español  
**800.592.9995** (M-F 7AM-5PM)  
This material will be provided in alternate formats upon request.  
Online Billing: [wm.com/wm/ezpay](http://wm.com/wm/ezpay)

THINK GREEN.®



# Your King County Recycling Guide



THINK GREEN.®

# Recycling

Clean recyclables go in your blue recycling cart

Ignore numbers on plastic containers. Put only bottles, jugs, cups and tubs in recycling.

## Clean Paper & Newspaper

Newspaper, inserts

Mail, envelopes

Cereal, dry food boxes  
(remove liner)

Paperback books

Magazines, catalogs, phone books

Non-foil wrapping paper

Frozen food boxes

Juice boxes

Paper cups



Milk, soy milk & broth cartons



Shredded paper is difficult to separate from other recyclables. It is accepted in yard/food carts.

## Cardboard

Flatten



## Glass Jars & Bottles

Empty and rinse out  
Labels OK



## Plastic Bottles, Jugs, Cups & Tubs

Empty and rinse; no lids

Milk, juice & soda bottles

Yogurt, dairy & margarine tubs

Plastic cups

Shampoo & conditioner bottles

Window, bathroom & kitchen cleaner bottles

Detergent & fabric softener bottles

Pill bottles  
(no prescription vials)



## Aluminum & Tin Cans

Empty and rinse out food residue  
Labels OK

Soda cans

Metal food cans

Aerosol cans  
(empty and non-toxic)



Plastic bags contaminate other recyclables. Bag plastic bags and take them to a grocery store for recycling. Even better, use a reusable bag.

## Scrap Metal

(small non-working metal appliances, pots, tools, etc.)  
Limit 2 ft. x 2 ft. x 2 ft., 35 lbs;  
no wood, plastic, or rubber attachments; no sharp metal



## RECYCLING

- Empty clean recyclables out of bags and boxes into the cart so that they can be easily sorted.
- Put all recyclables in blue recycling cart.
- Blue recycling carts are emptied every **other week**. (See enclosed calendar.)
- Put extra recycling in 32-gallon containers with handles and lids. Label "Recycle."\*\*  
\* There is no charge for extra recycling.

Not sure? Check it out at [wmnorthwest.com](http://wmnorthwest.com)

# Food & Yard Waste

These go in your gray yard & food cart

No plastic,  
glass or metal

Fruit & vegetable scraps; leftovers

Bread, pasta, grains

Eggshells, nutshells

Coffee filters & grounds

Teabags & tea leaves

Meat, fish, poultry, beans

Dairy products  
(yogurt, cheese, etc.)



Greasy paper or cardboard takeout and delivery boxes

Food soiled paper towels, napkins

Shredded paper (*layered*)

Paper grocery bags containing food scraps

Soiled paper egg & berry cartons

Waxed paper & cardboard

Uncoated (non-shiny) paper plates, cups, food wrap & bags

Approved compostable packaging (*more items at [gogreenscene.com](http://gogreenscene.com)*)



Sign up for food/yard service at [wmnorthwest.com](http://wmnorthwest.com) or call **800.592.9995** (M-F 7AM-5PM).

Houseplants (*no pots*)

Tree branches  
(*under 4' long, 4" in diam.*)

Holiday trees,  
Jack-o-lanterns  
(*remove candle*)



Weeds

Twigs, branches,  
roots from pruning

Grass clippings,  
leaves



## Collect food scraps. It's easy to do.

- Use a collection method that works for you.
  - a sink collander strainer
  - a paper grocery bag
  - a reusable plastic, metal or ceramic container with a lid
  - newspaper
  - an approved compostable bag ([recyclefood.com](http://recyclefood.com))
- Empty your container into the food/yard cart frequently.
- Layer food scraps with yard waste, newspaper or shredded paper to absorb liquids.



## Where does it go?

Food scraps and yard trimmings are processed into compost and sold at home and garden stores.

**Extra Yard Waste:** There is charge for extra yard waste. Put extra yard waste in Kraft paper bags or 32-gallon containers with handles and lids (*65lb limit*). Label "yard."

Not sure? Check it out at [wmnorthwest.com](http://wmnorthwest.com)

# Garbage

Bag these and put them in your garbage

## Non-recyclable Plastic

Take-out containers

Styrofoam, packing peanuts

Caps, lids

Stretch wrap

Empty motor oil & antifreeze containers

Plastic bakery & meat trays

Plastic plates & utensils

Empty prescription vials

Garden hoses



## Non-recyclable Glass

Mirrors, window glass

Ceramics, dishes

Incandescent & halogen light bulbs only  
(Fluorescent light bulbs and tubes need special disposal — see next page)



## Non-recyclable Metal

Caps, lids

Aluminum foil, foil trays

Oil containers



## Non-recyclable Paper

Disposable diapers

Ribbons, foil wrapping paper

Dirty paper, facial tissue



Hardened paint in cans  
(remove lid)

Sharp or greasy metal

Clothes hangers

Small non-working plastic appliances  
(toasters, microwaves, coffee makers, etc.)

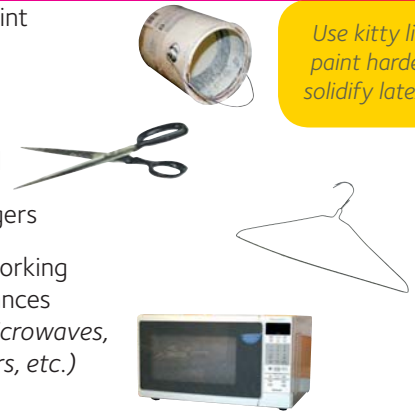

Use kitty litter or paint hardener to solidify latex paint.

Donate books to a local charity or school.

GARBAGE

### Please:

- Bag all garbage.
- Double bag pet waste and pet litter, packing pellets, vacuum dust, sawdust, and cold ashes.
- **Weight limit: 32-gal/65 lbs** for your collector's safety.

**Garbage** charges are based on container size. There is a charge for extra garbage that doesn't fit in your container with the lid closed. Bulky items like mattresses, appliances, and building materials can be picked up by special arrangement for a fee.

Not sure? Check it out at [wmnorthwest.com](http://wmnorthwest.com)

# What Do I Do With?

Some items such as medical wastes, fluorescent bulbs and tubes, needles, fuel tanks, electronics and chemicals are hazardous or hard to handle and are not allowed in garbage or recycling. They require special handling as indicated below.

**Motor Oil** Put in tightly closed in 1 gallon milk jugs and take to a hazardous waste facility.

- [lhwmp.org](http://lhwmp.org)
- 206.296.4692

## Computers, Monitors and TVs

Free recycling locations:

- [takeitbacknetwork.org](http://takeitbacknetwork.org)
- [ecyclewashington.org](http://ecyclewashington.org)
- 800.RECYCLE (732.9253)



## Cell Phones & Other Electronics

(printers, fax machines, DVD players, etc.):

- [takeitbacknetwork.org](http://takeitbacknetwork.org)
- 206.296.4466



**Large Appliances** (refrigerators, freezers, dishwashers, clothes washers, dryers, stoves, ranges, furnaces, etc.)

- Sell, donate or give away
- [kingcounty.gov/whatdoidowith](http://kingcounty.gov/whatdoidowith)



**Batteries** (rechargeable, button, alkaline, lead acid automobile, UPS)

- [lhwmp.org](http://lhwmp.org)
- [thinkgreenfromhome.com](http://thinkgreenfromhome.com)
- [call2recycle.org](http://call2recycle.org)
- [kingcounty.gov/whatdoidowith](http://kingcounty.gov/whatdoidowith)



*Use rechargeable batteries.  
Many stores accept rechargeable  
batteries for recycling.*

There are many alternatives to putting unwanted items in the garbage. If an item is in good condition, donate it or give it away.

## Plastic Bags & Dry Cleaning Bags

Plastic bags become litter and endanger wildlife.

- Use durable bags
- Reuse plastic bags
- Recycle at grocery store
- [bagyourbags.com](http://bagyourbags.com)



## Clothing & Shoes

- Donate to second hand stores such as Goodwill or your local consignment shop

**Mercury-containing Products** (mercury switches, thermometers, thermostats, etc.)

- [lhwmp.org](http://lhwmp.org)
- 206.296.4692

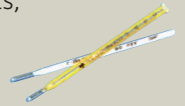

## Fluorescent Bulbs & Tubes

- [thinkgreenfromhome.com](http://thinkgreenfromhome.com)
- [takeitbacknetwork.org](http://takeitbacknetwork.org)
- 206.296.4466



**Needles/Syringes** Used needles and syringes are dangerous in garbage and recycling because they can injure residents, collectors, and sorters, as well as spreading diseases.

- Take syringes to a pharmacy
- Use Sharps by mail – [thinkgreenfromhome.com](http://thinkgreenfromhome.com)



## Oil-Based Paint, Chemicals, Pesticides, Propane Tanks & Automobile Fluids

Household Hazardous Facilities: various locations and hours.

- [lhwmp.org](http://lhwmp.org)
- 206.296.4692



## Styrofoam Blocks & Packing Peanuts, Toilets, Tires, Cooking Oil, Medication... and more!

- [kingcounty.gov/whatdoidowith](http://kingcounty.gov/whatdoidowith); 206.296.4466
- [1800recycle.wa.gov](http://1800recycle.wa.gov); 800.RECYCLE (732.9253)

## Online Materials Exchange

- Craigslist: [seattle.craigslist.org](http://seattle.craigslist.org)
- 2Good2Toss: [2good2toss.com](http://2good2toss.com)
- The Freecycle Network: [freecycle.org](http://freecycle.org)

Not sure? Check it out at [wmnorthwest.com](http://wmnorthwest.com)



# Collection Guidelines



## Weather Delay?

If weather conditions prevent safe collection, up to twice as much material will be collected at no extra charge on your next regular collection day for each container not emptied. No credit for collection delayed due to weather.



## Place carts at curb by 6AM

- Two (2) feet apart with lids opening toward street
- At least three (3) feet from cars, trees and mailboxes
- Please take containers in as soon as possible after collection

Visit [wmnorthwest.com](http://wmnorthwest.com) or call **800.592.9995** (M-F 7AM-5PM) for:

- **Missed collection**
- **Missing/damaged carts**
- **Collection rates or service subscription**
- **Bulky item collection** (*mattresses, appliances, etc.*)
- **Construction/demolition containers** (*remodeling, etc.*)
- **Disabled service**

Waste Prevention  
is Even Better  
Than  
Recycling!



## Before you buy, use or discard an item, ask yourself:

**Reduce:** Can I buy this product with less packaging?

**Reuse:** Can I or someone else use this again?

**Recycle:** Can I recycle this after I use it?

**Buy Recycled:** Can I get this item with recycled content?

## Resources

### Waste Management

[wmnorthwest.com](http://wmnorthwest.com) • 800.592.9995

### What Do I Do With?

[kingcounty.gov/whatdoidowith](http://kingcounty.gov/whatdoidowith)  
206.296.4466

### 800RECYCLE

[1800recycle.wa.gov](http://1800recycle.wa.gov)

800.RECYCLE (732.9253)

Online information to help you dispose of materials properly.

### Take it Back Network

[takeitbacknetwork.org](http://takeitbacknetwork.org) • 206.296.4466

Recycle electronics and mercury-containing fluorescent bulbs and tubes.

### Household Hazardous Waste

[lhwmp.org](http://lhwmp.org) • 206.296.4692

### E-cycle Washington

[ecyclewashington.org](http://ecyclewashington.org)  
800.RECYCLE (732.9253)

Free recycling locations for computers, monitors and TVs.

### Sharps Mail Back Program

[thinkgreenfromhome.com](http://thinkgreenfromhome.com)  
[kingcounty.gov/whatdoidowith](http://kingcounty.gov/whatdoidowith)

**Environmental Kids Club** • [epa.gov/kids](http://epa.gov/kids)

### Illegal Dumping Hotline

206.296.SITE (7483)

**Classroom Resources** • [thinkgreen.com](http://thinkgreen.com)

Not sure? Check it out at [wmnorthwest.com](http://wmnorthwest.com)